



## 43a Russell Street, Wilton, Salisbury, Wiltshire, SP2 0BG

\*\*\* VIEWINGS ON HOLD DUE HIGH DEMAND\*\*\*

- LOCATED IN CENTRE OF WILTON
- TWO BEDROOM
- ATTACHED COTTAGE
- SMALL COURTYARD AREA
- OFF ROAD PARKING
- DOUBLE GLAZED
- GAS CENTRAL HEATING
- EPC – D
- COUNCIL TAX BAND – C

**£900 Per Calendar Month**

### Ground Floor

Approx. 32.9 sq. metres (353.8 sq. feet)

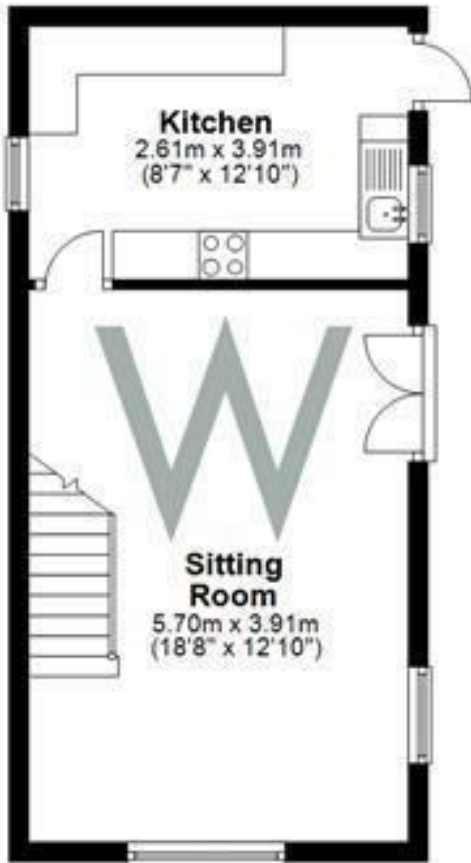

### First Floor

Approx. 32.9 sq. metres (353.8 sq. feet)

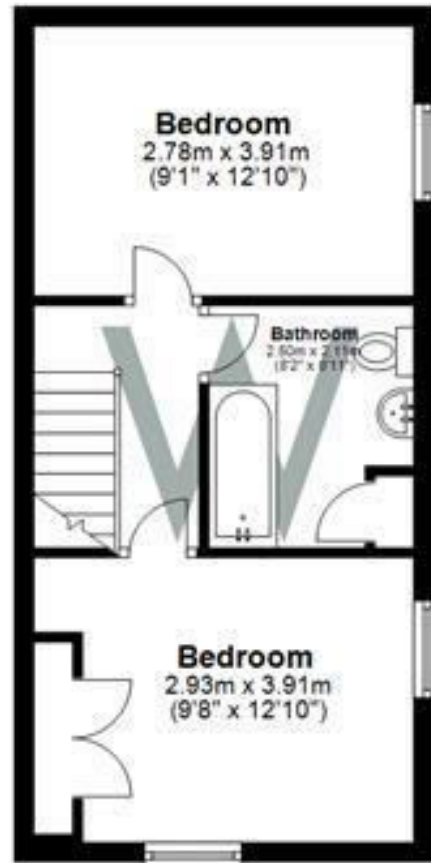

Total area: approx. 65.7 sq. metres (707.6 sq. feet)

#### WHITES

Castle Chambers, 47 Castle Street, Salisbury,  
Wiltshire, SP1 3SP  
Tel: 01722 336422/Option 2  
www.hwwhite.co.uk  
email: lettings-management@hwwhites.co.uk

Energy Efficiency Rating		Current	Potential
Very energy efficient - lower running costs			
(92 plus) <b>A</b>			88
(81-91) <b>B</b>			
(69-80) <b>C</b>			
(55-68) <b>D</b>		65	
(39-54) <b>E</b>			
(21-38) <b>F</b>			
(1-20) <b>G</b>			
Not energy efficient - higher running costs			
England & Wales		EU Directive 2002/91/EC	

Environmental Impact (CO <sub>2</sub> ) Rating		Current	Potential
Very environmentally friendly - lower CO <sub>2</sub> emissions			
(92 plus) <b>A</b>			
(81-91) <b>B</b>			
(69-80) <b>C</b>			
(55-68) <b>D</b>			
(39-54) <b>E</b>			
(21-38) <b>F</b>			
(1-20) <b>G</b>			
Not environmentally friendly - higher CO <sub>2</sub> emissions			
England & Wales		EU Directive 2002/91/EC	